

JUNE ISSUE OF
BRUCE'S
FUNZINE
APPROVED BY
THE COUNCIL FOR
WEIRD MAGAZINES

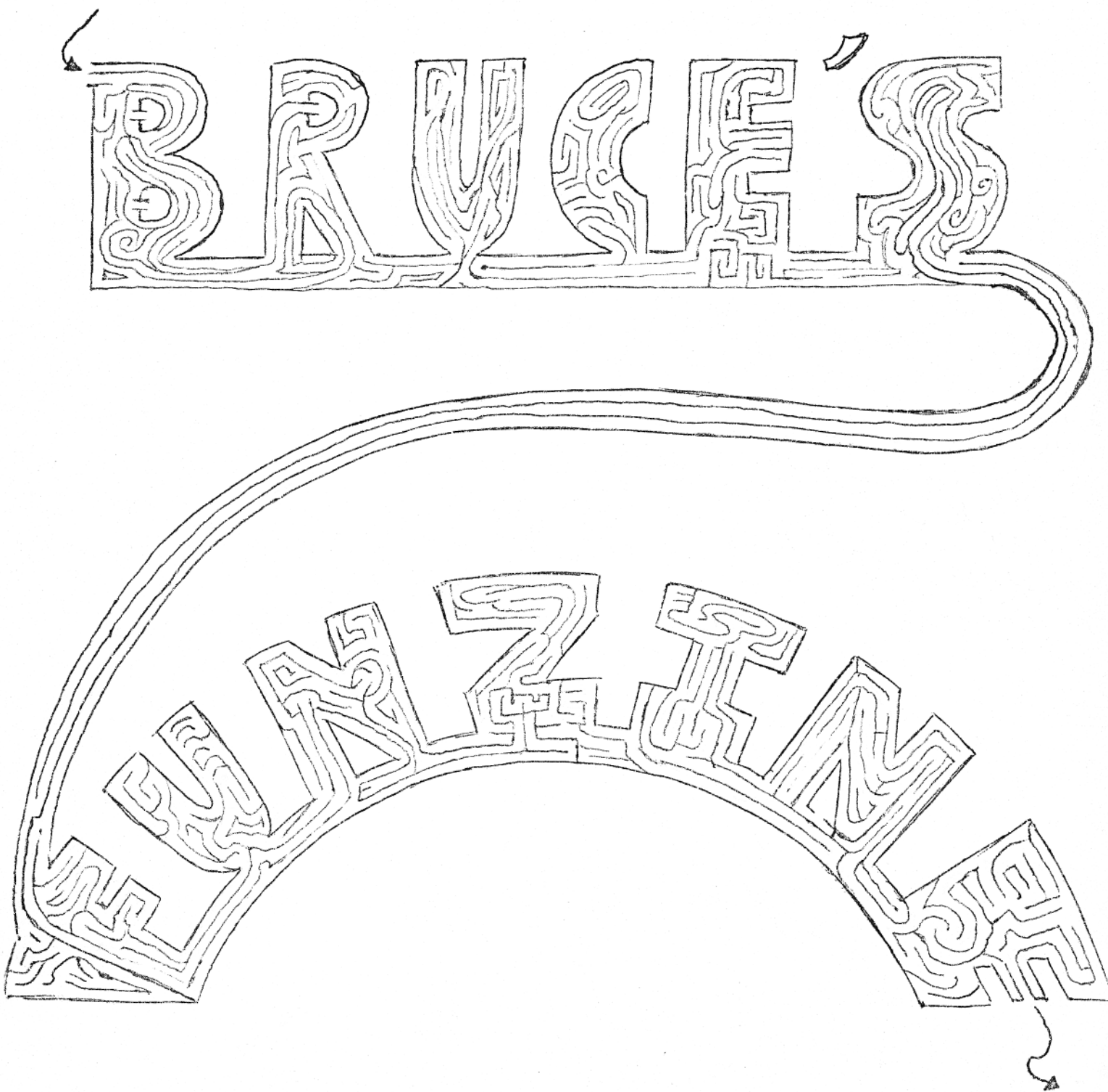

As you can see this month's issue is featuring mazes. On the one below try to find the right path through the maze.

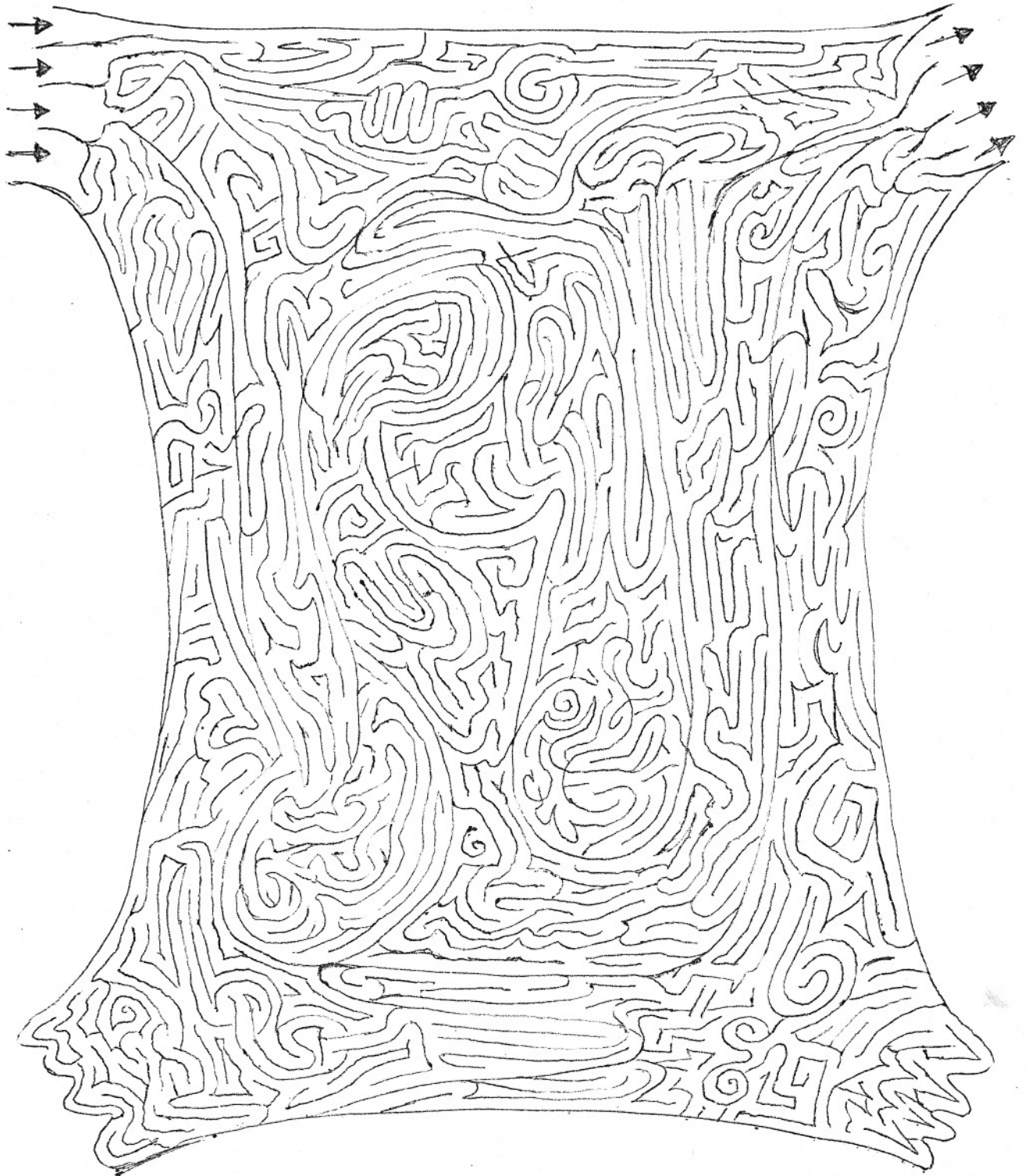

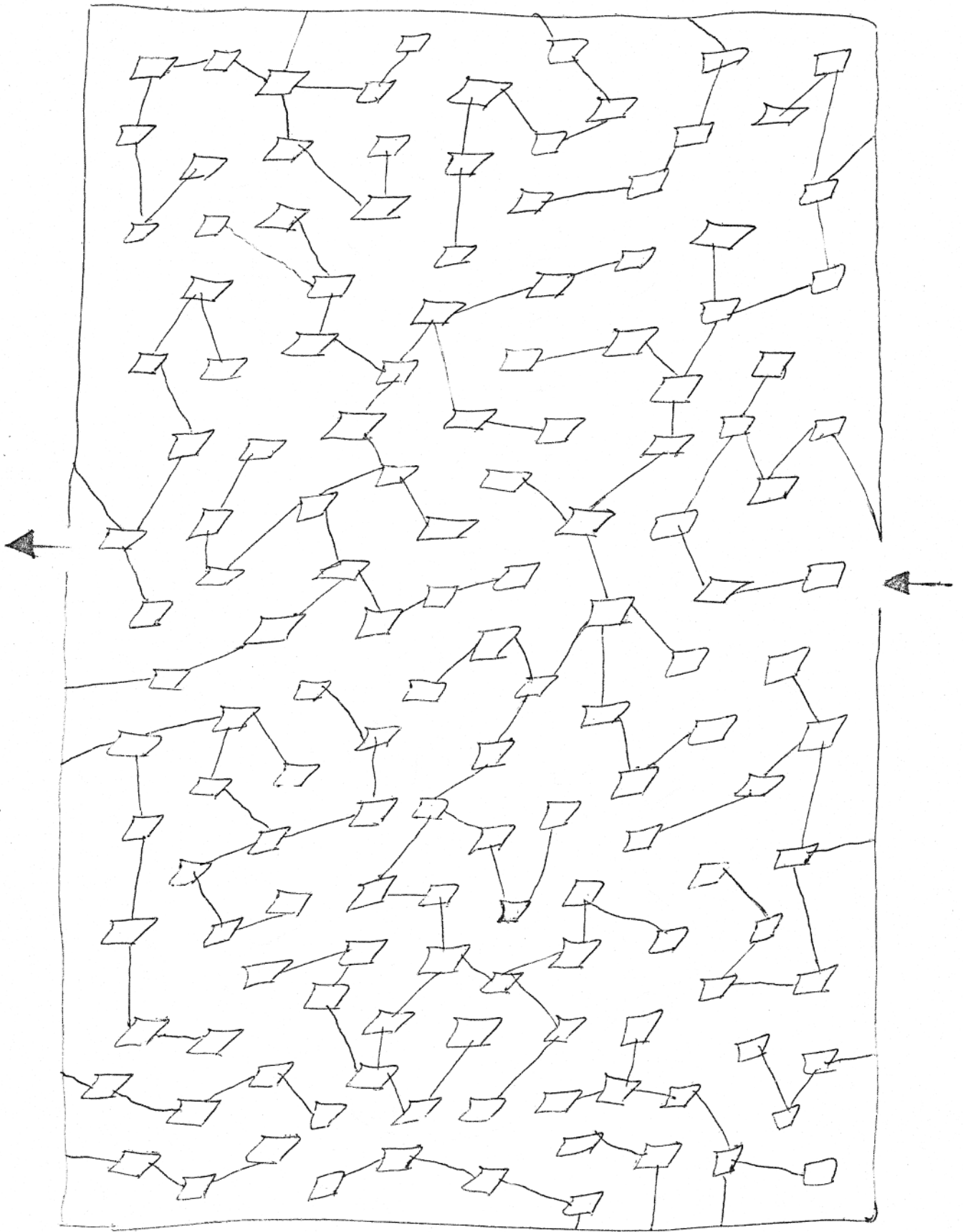

Here are two classic mazes that you might want to try.

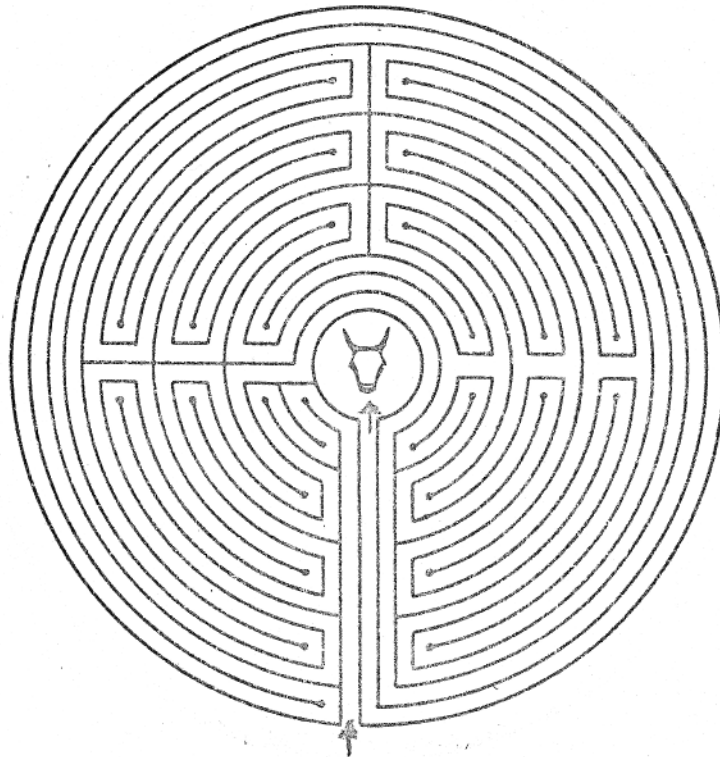
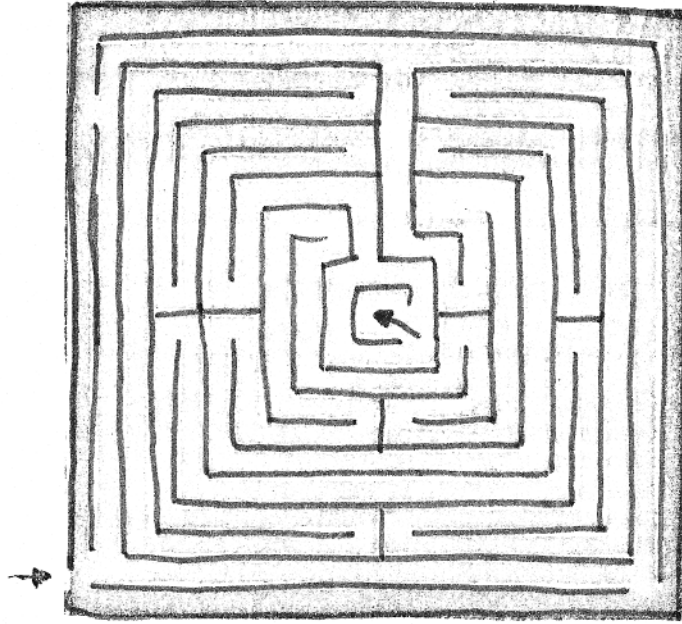

To make it through this maze, go from white, to black, to striped, and keep on repeating this pattern, until you're finished. You can go horizontally and vertically, but not diagonally.

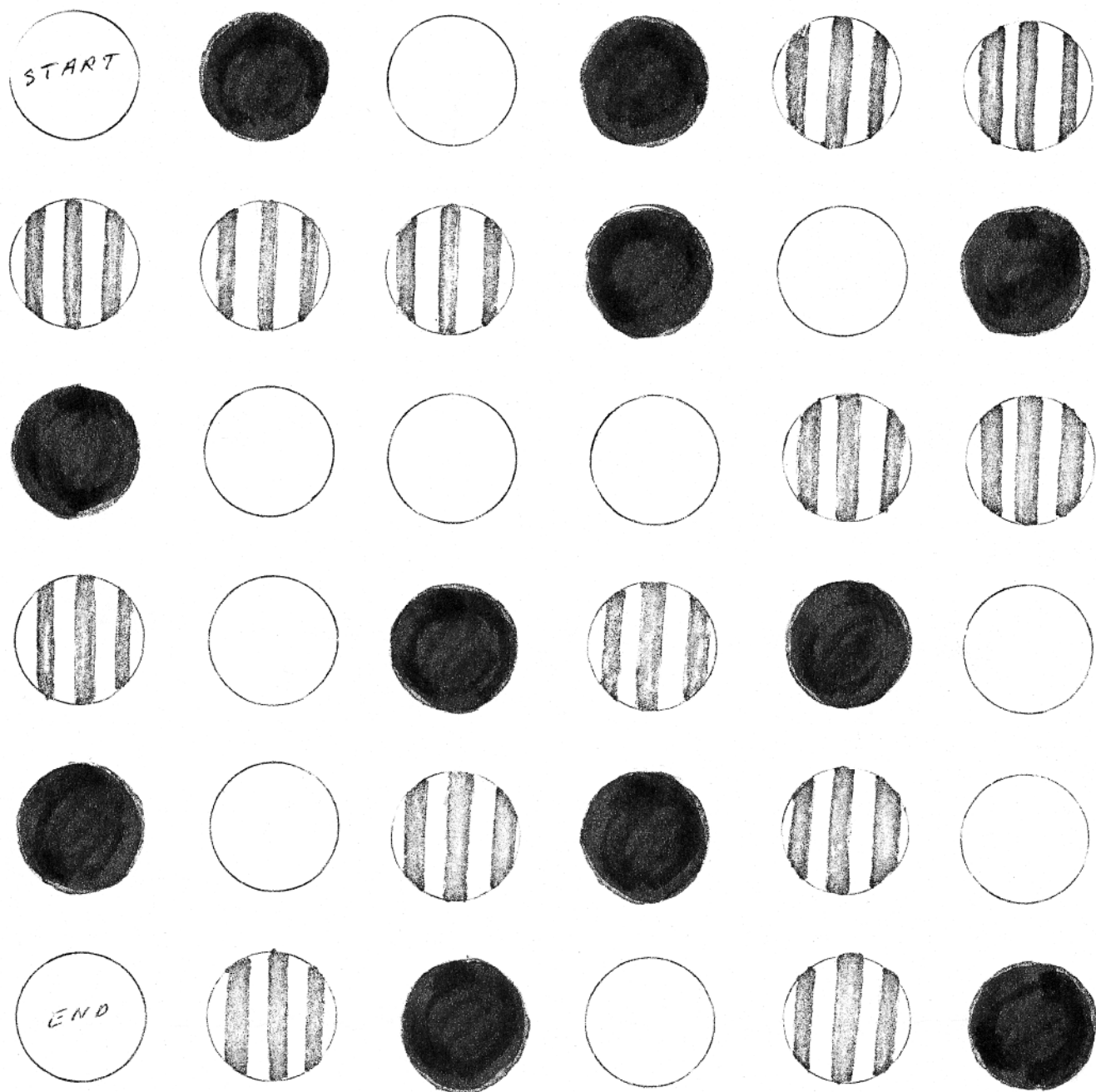

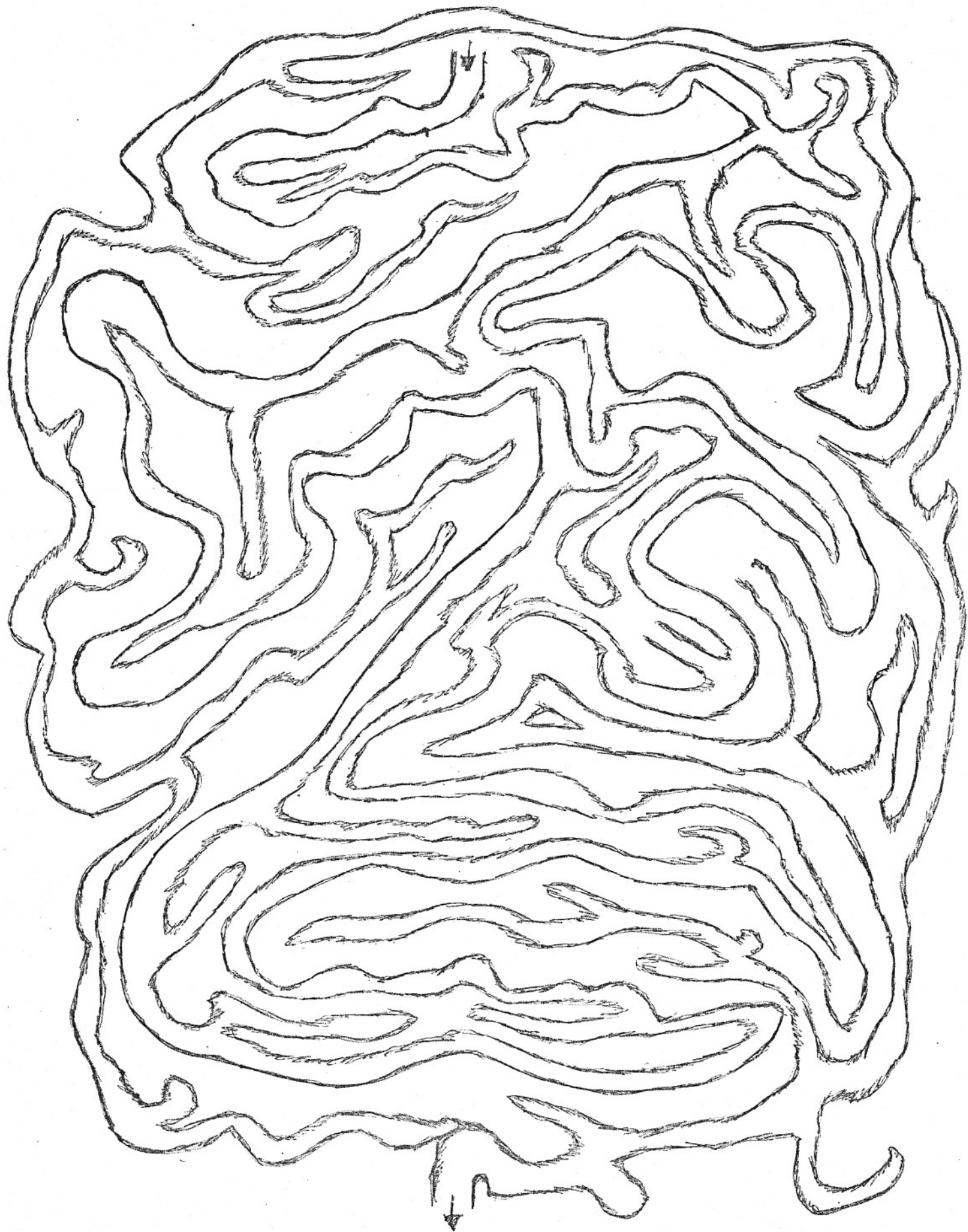

BRICK WALL

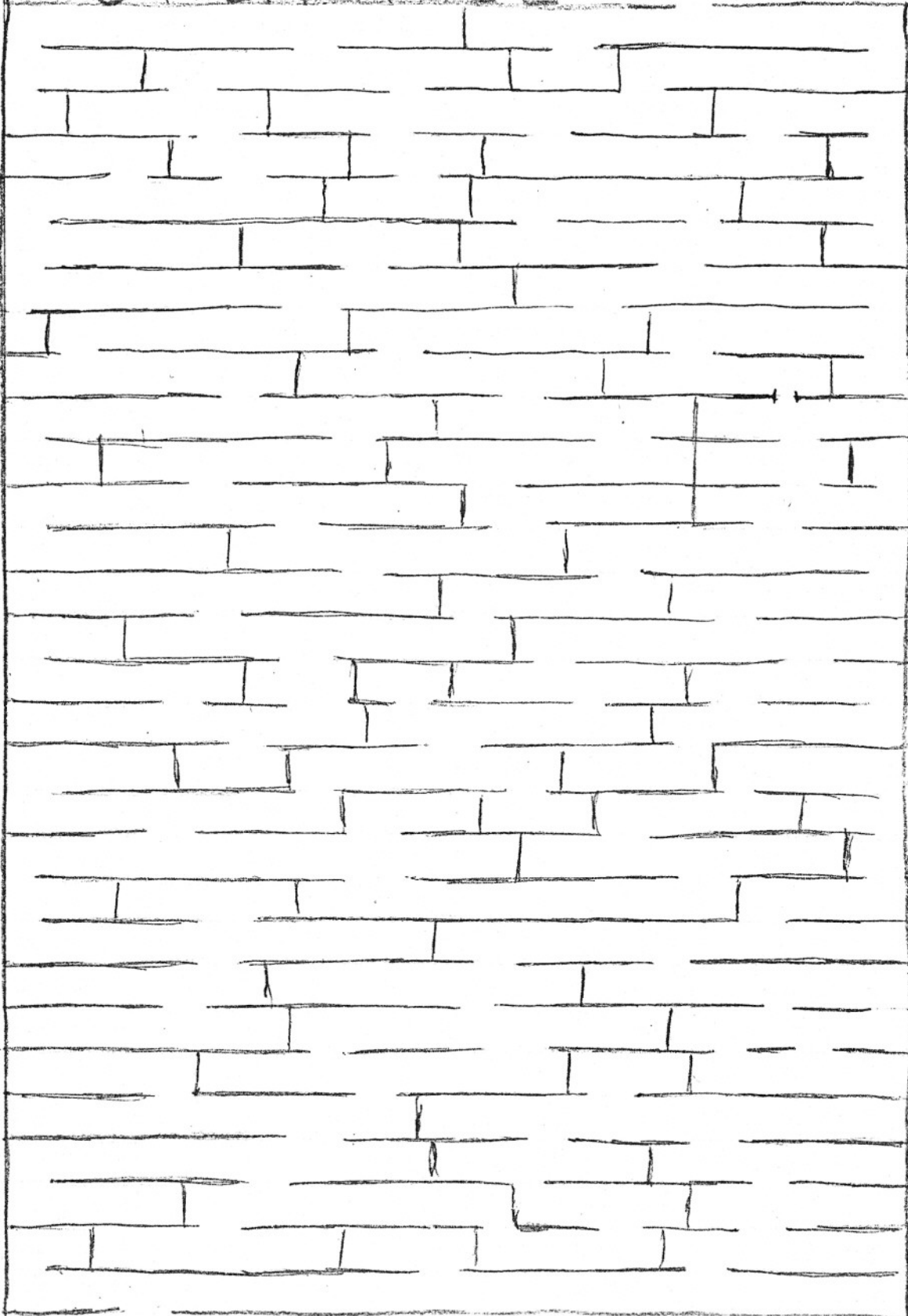

Make it through this maze without
going against the arrows, if you
get trapped start over again.

